

MOUNTING PANEL
 For additional units, add 1.03[26.2] per unit.
 For more than 2 V-Series Switches, add
 middle section. Available in Panel Thicknesses
 listed below.

MOUNTING PANEL THICKNESS
 .062[1.57]
 .093[2.36]
 1.25[3.17]

.187[4.75]
 .250[6.35]
 .375[9.52]

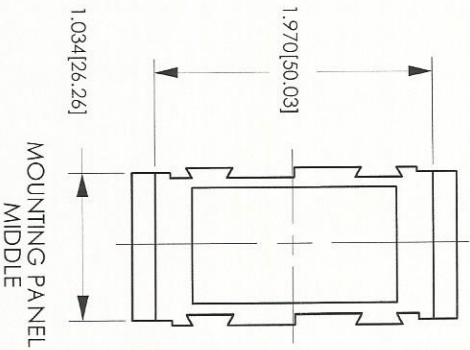
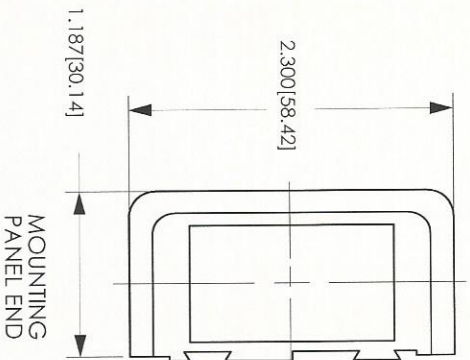
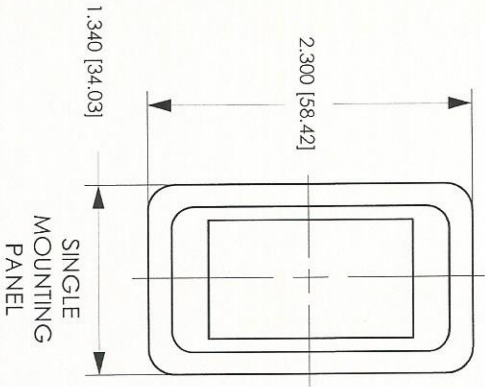
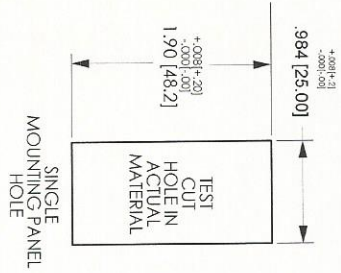

SWITCH MOUNTING PANELS